

The bracket is designed to accommodate a 2-mm-thick sheet material as a support.

* Example 3D print parameters *

- Material: PETG
- Nozzle: 0,4 mm
- Layer height: 0,24 mm
- Walls: 3
- Infill: 15%, Gyroid

* Not tested for full hood bag *

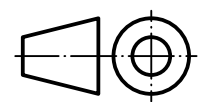

Part Material: not specified
 General tolerances: ISO 2768-m
 Scale: 1 : 1

Title: FullHoodWallBracket4Sevens		Created by: Erik Schuster		Owner:	
Document type: Component Drawing		Approved by:			
Drawing number: DN	Language: EN	Issue date: 02.07.26	Revision: 1.0	Sheet: 1 / 1	

* License: None commercial use only *

